

### Communal HUB and Water Pumping System

The communal HUB is design to assist with the blocks economic and communal affairs within itself and other blocks. The Water Pumping System connects the aquatic system with the vertical farming system.

### Residence Building

Connects with the other buildings at ground level and at the Green Roof.

### Green Roof

Community space allowing all the buildings to come together.

### Vertical Terrace Farm

Produces food inside and outside for the blocks community and economy. It is connected to the Commercial and Retail building by the Courtyard Level.

### Courtyard

Community Space connecting the terrace farm, commercial building and retail building.

### Commercial Building

Includes offices, retail space, some residences, and a communal physical fitness center for residents of the block.

### Retail Building

All 7 stories compacted with retail stores and privately owned specialty shops.

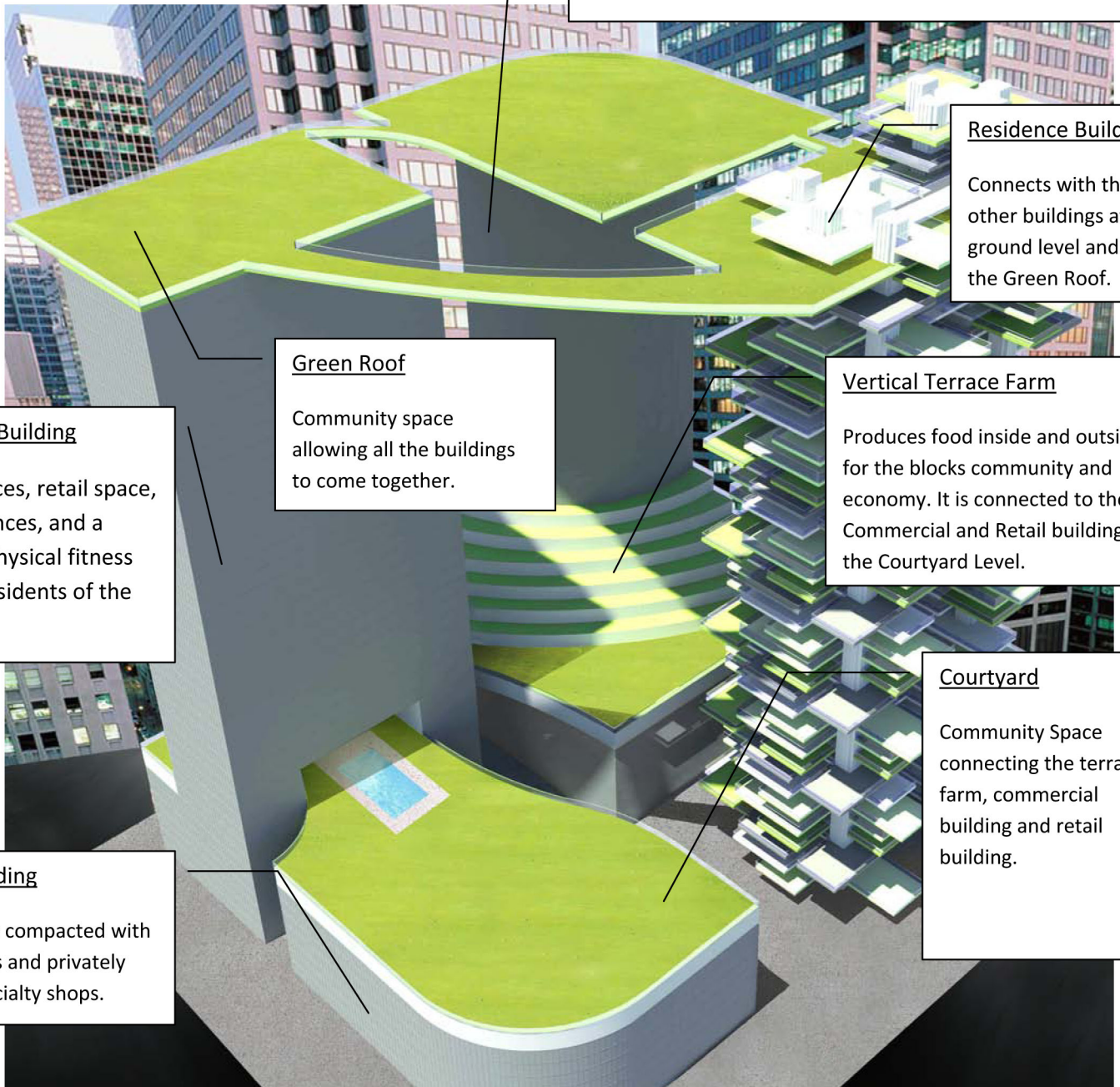



Commercial Building

Vertical Terrace Farm

Private Residence

One residence part of the main Residence Building.

Courtyard Level

Ground Level

Mainly a pedestrian space connecting all the buildings in the block at ground level.

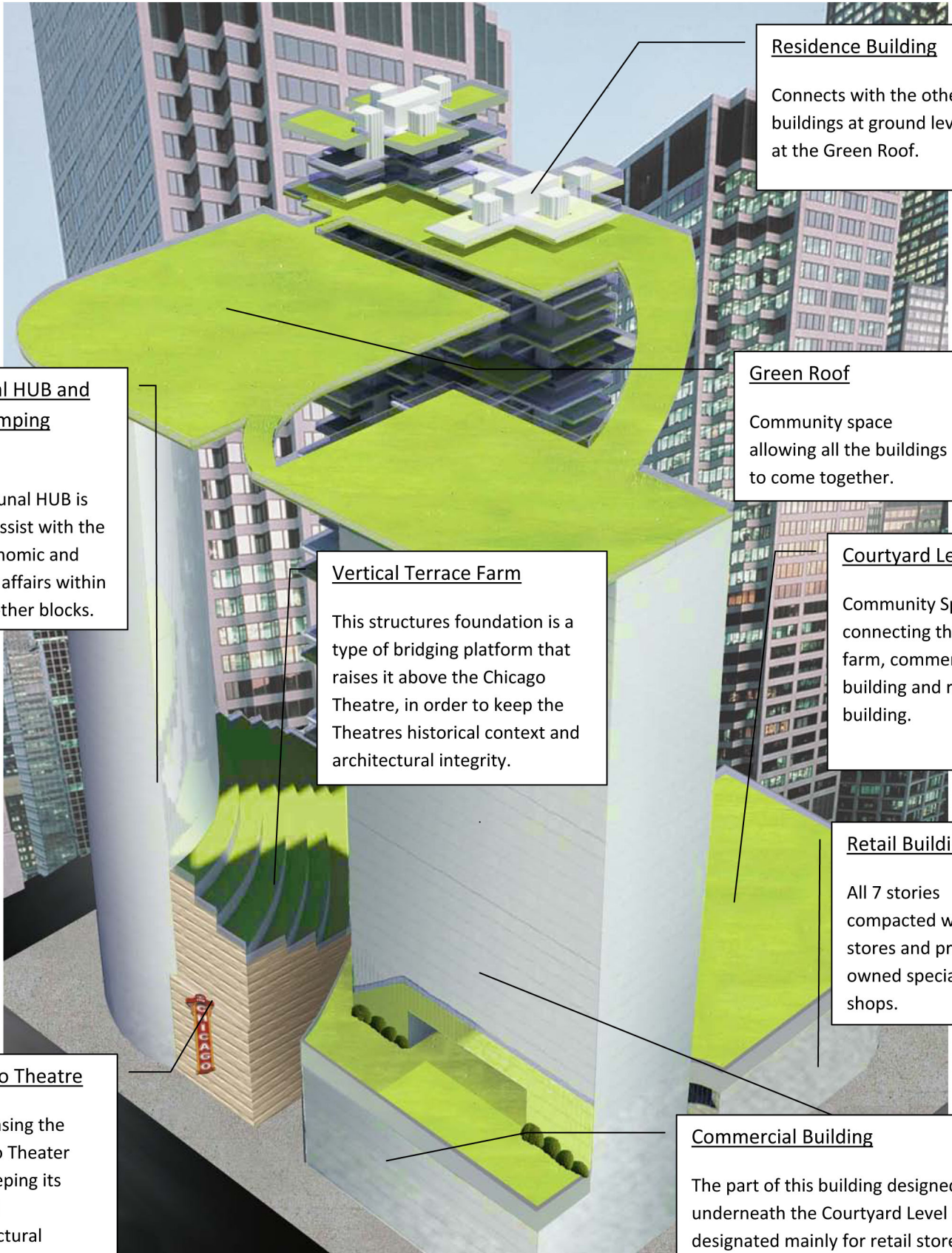

Residence Building  
Connects with the other buildings at ground level and at the Green Roof.

Green Roof  
Community space allowing all the buildings to come together.

Courtyard Level  
Community Space connecting the terrace farm, commercial building and retail building.

Retail Building  
All 7 stories compacted with retail stores and privately owned specialty shops.

Commercial Building  
The part of this building designed underneath the Courtyard Level is designated mainly for retail stores. The area above the Courtyard Level is mainly for offices and some residences.

Vertical Terrace Farm  
This structures foundation is a type of bridging platform that raises it above the Chicago Theatre, in order to keep the Theatres historical context and architectural integrity.

Communal HUB and Water Pumping System  
The communal HUB is design to assist with the blocks economic and communal affairs within itself and other blocks.

Chicago Theatre  
Showcasing the Chicago Theater and keeping its original architectural integrity was one of the main focuses while designing this particular block.

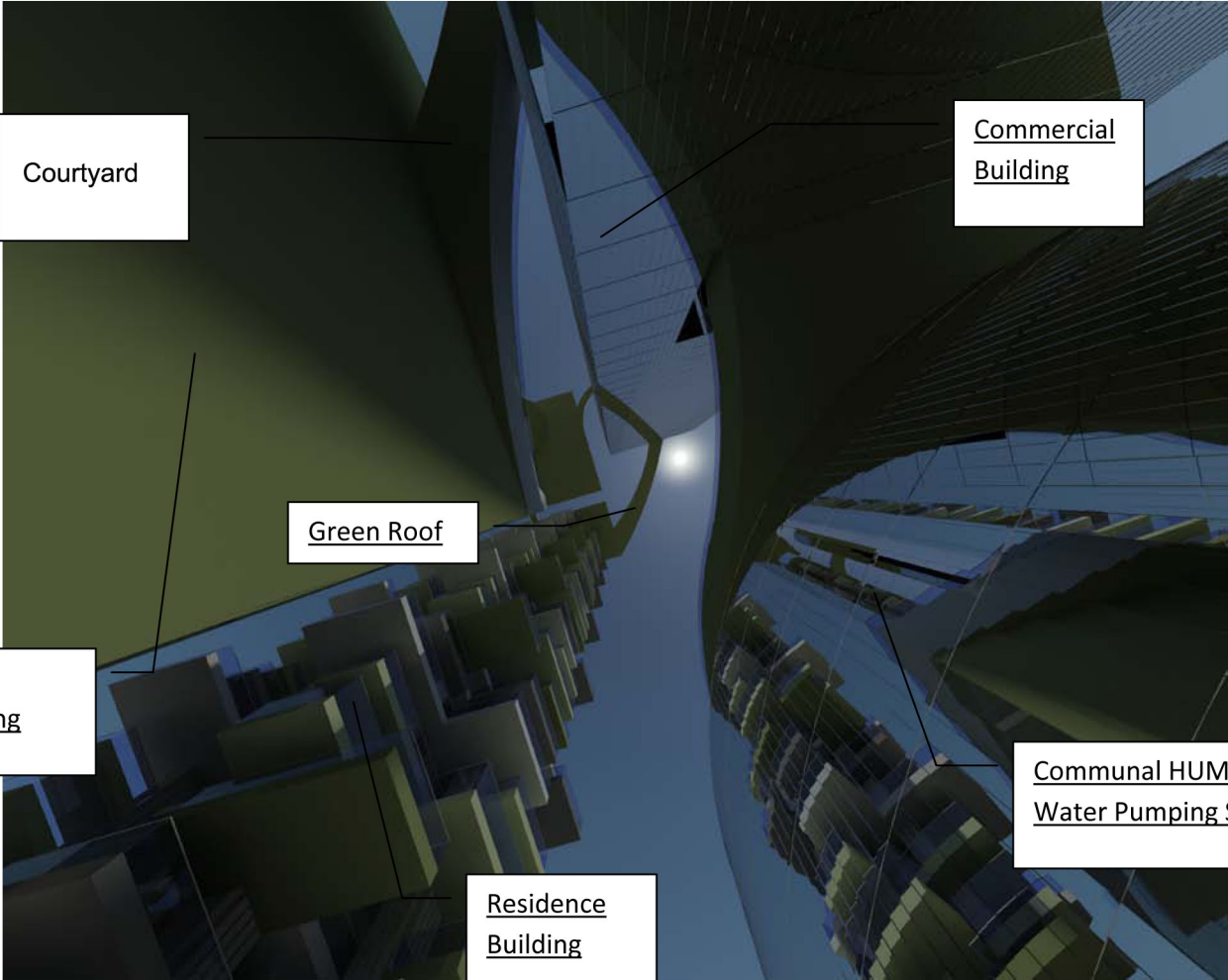

Courtyard

Commercial Building

Green Roof

Retail Building

Communal HUM and Water Pumping System

Residence Building

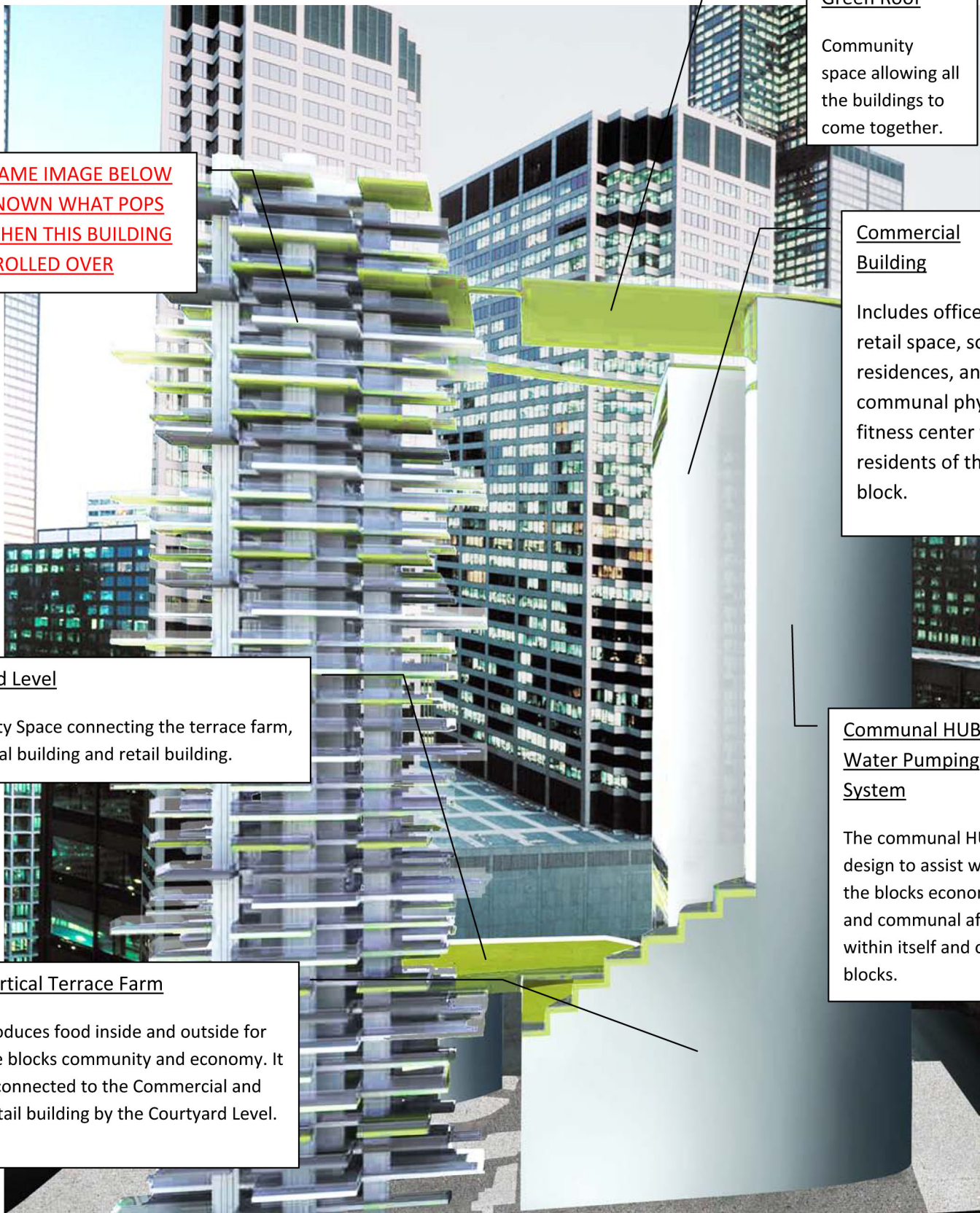

SEE SAME IMAGE BELOW TO KNOW WHAT POPS UP WHEN THIS BUILDING IS SCROLLED OVER

Green Roof  
Community space allowing all the buildings to come together.

Commercial Building  
Includes offices, retail space, some residences, and a communal physical fitness center for residents of the block.

Courtyard Level  
Community Space connecting the terrace farm, commercial building and retail building.

Communal HUB and Water Pumping System  
The communal HUB is design to assist with the blocks economic and communal affairs within itself and other blocks.

Vertical Terrace Farm  
Produces food inside and outside for the blocks community and economy. It is connected to the Commercial and Retail building by the Courtyard Level.

## Residence Buildings

The concept for these buildings is to allow them to grow as the blocks population grows. In other words, instead of designing a building that houses a specific number of units that may go unoccupied for a number of years, these buildings are designed to actually add on units as they are bought and needed due to population growth.

There were several innovative concepts when it came to designing a building that represented a “growing building”. The final idea which is implemented in the city block was inspired by external elevators used in present times mainly on building construction sites.

Initially each resident building is designed with a main core containing fire escape stairs, a passenger elevator big enough to house cargo, center plains connecting the properties on every level, and four individual elevators with exoskeleton systems containing exterior elevators.

Residents choose between pre-shaped and pre-sized land-properties that they can implement in any way they choose. For example they can use their property for gardening, building a custom house, or both, along with anything else made pliable by city codes and residents creativity. Once their property is designed custom to the resident’s approval, it is attached to one or more of the exoskeleton systems containing exterior elevators. With innovative building materials supplied in 2040, these exoskeleton elevator systems potentially secure the properties of the residents. Overtime, when new residents purchase properties to add onto the infrastructure, the existing properties are simply lifted up with the exoskeleton elevator system.

As the building continues to grow up the core elevator brings up prefabricated building parts and elevator sections to add onto the existing infrastructure. To solve the problem of not knowing what floor you are living on due to the fact that can change weekly, residents will have a property password to plug into the individual elevators that will program the elevator to bring that specific person to their specific floor. Every five floor contains plains that connect the two resident’s buildings, providing more communal space to the block.

Ultimately this building is able to continue to grow with the growth of the society’s population.

